

RT-20

PRESSURE/TORQUE CONVERSION CHART

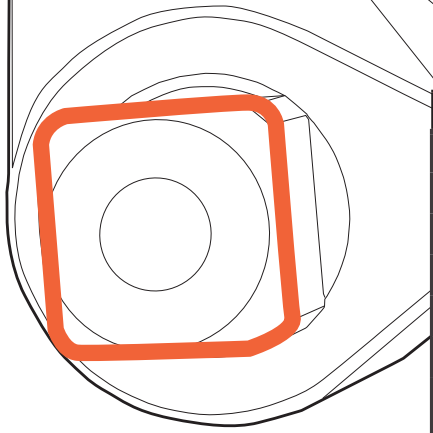

RAPID-TORC®
 B I G N U T S - B I G T O O L S
 WWW.RAPIDTORC.COM



PRESSURE IN PSI	FT. LBS.	KGM	NM	PRESSURE IN BAR
1500	2960	409	4013	104
1600	3158	437	4281	110
1800	3554	492	4818	124
2000	3950	546	5355	138
2200	4346	601	5891	152
2400	4742	656	6428	165
2600	5138	711	6965	179
2800	5534	765	7502	193
3000	5930	820	8039	207
3200	6325	875	8574	220
3400	6720	929	9110	234
3600	7115	984	9645	248
3800	7510	1039	10181	262
4000	7905	1093	10716	276
4200	8300	1148	11251	290
4400	8695	1203	11787	303
4600	9090	1257	12322	317
4800	9485	1312	12858	331
5000	9880	1366	13393	345
5200	10276	1421	13930	358
5400	10672	1476	14467	372
5600	11068	1531	15004	386
5800	11464	1585	15541	400
6000	11860	1640	16077	414
6200	12254	1695	16612	427
6400	12648	1749	17146	441
6600	13042	1804	17680	455
6800	13436	1858	18214	468
7000	13830	1913	18748	482
7200	14226	1967	19285	496
7400	14622	2022	19822	510
7600	15018	2077	20358	524
7800	15414	2132	20895	538
8000	15810	2187	21432	552
8200	16205	2241	21967	565
8400	16600	2296	22503	579
8600	16995	2350	23038	593
8800	17390	2405	23574	607
9000	17785	2460	24109	620
9200	18180	2514	24645	634
9400	18575	2569	25180	648
9600	18970	2624	25716	662
9800	19365	2678	26251	676
10000	19760	2733	26787	690

RAPID-TORC is an International Corporation, based in Houston, TX and Brussels, Belgium. Leader in the Bolting market, the company designs, manufactures and distributes high quality hydraulic torque wrenches, bolt tensioners and induction heating systems and delivers value-added technical services to customers worldwide.

QUICK SETUP

1

Connect your socket to your square drive. **ALWAYS** use the safety connector pin and the safety ring for added safety.



2

Make sure your hoses are free of any defects. Connect hose to the corresponding couplers on the pump and tool.

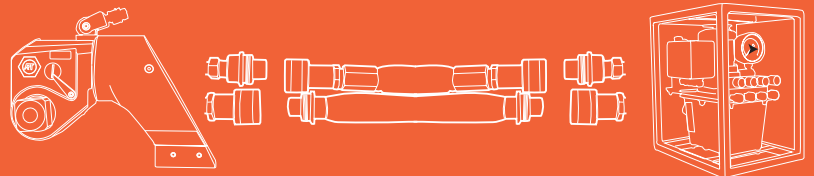

3

Cycle the tool.

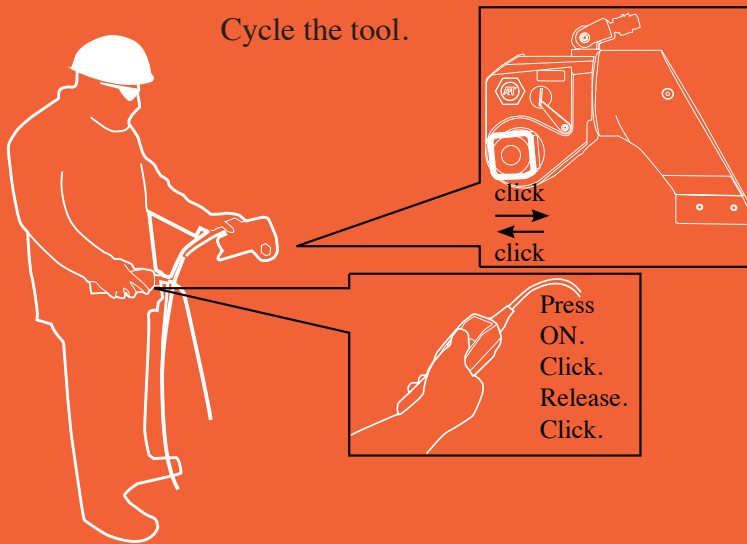

4

NOTE: Easy to remember tool position for tightening and loosening.

Tightening.



Loosening.



5

Use the pressure/torque conversion chart to set the psi for the torque value you need.

NOTE: Only use the chart that corresponds to the tool you are using.

RT-10		Pressure (psi)	Torque (ft-lb)
1/4"	1/2"	100	10
1/4"	3/4"	100	15
1/4"	1"	100	20
1/4"	1 1/4"	100	25
1/4"	1 1/2"	100	30
1/4"	1 3/4"	100	35
1/4"	2"	100	40
1/4"	2 1/4"	100	45
1/4"	2 1/2"	100	50
1/4"	2 3/4"	100	55
1/4"	3"	100	60
1/4"	3 1/4"	100	65
1/4"	3 1/2"	100	70
1/4"	3 3/4"	100	75
1/4"	4"	100	80
1/4"	4 1/4"	100	85
1/4"	4 1/2"	100	90
1/4"	4 3/4"	100	95
1/4"	5"	100	100
1/4"	5 1/4"	100	105
1/4"	5 1/2"	100	110
1/4"	5 3/4"	100	115
1/4"	6"	100	120
1/4"	6 1/4"	100	125
1/4"	6 1/2"	100	130
1/4"	6 3/4"	100	135
1/4"	7"	100	140
1/4"	7 1/4"	100	145
1/4"	7 1/2"	100	150
1/4"	7 3/4"	100	155
1/4"	8"	100	160
1/4"	8 1/4"	100	165
1/4"	8 1/2"	100	170
1/4"	8 3/4"	100	175
1/4"	9"	100	180
1/4"	9 1/4"	100	185
1/4"	9 1/2"	100	190
1/4"	9 3/4"	100	195
1/4"	10"	100	200
1/4"	10 1/4"	100	205
1/4"	10 1/2"	100	210
1/4"	10 3/4"	100	215
1/4"	11"	100	220
1/4"	11 1/4"	100	225
1/4"	11 1/2"	100	230
1/4"	11 3/4"	100	235
1/4"	12"	100	240
1/4"	12 1/4"	100	245
1/4"	12 1/2"	100	250
1/4"	12 3/4"	100	255
1/4"	13"	100	260
1/4"	13 1/4"	100	265
1/4"	13 1/2"	100	270
1/4"	13 3/4"	100	275
1/4"	14"	100	280
1/4"	14 1/4"	100	285
1/4"	14 1/2"	100	290
1/4"	14 3/4"	100	295
1/4"	15"	100	300
1/4"	15 1/4"	100	305
1/4"	15 1/2"	100	310
1/4"	15 3/4"	100	315
1/4"	16"	100	320
1/4"	16 1/4"	100	325
1/4"	16 1/2"	100	330
1/4"	16 3/4"	100	335
1/4"	17"	100	340
1/4"	17 1/4"	100	345
1/4"	17 1/2"	100	350
1/4"	17 3/4"	100	355
1/4"	18"	100	360
1/4"	18 1/4"	100	365
1/4"	18 1/2"	100	370
1/4"	18 3/4"	100	375
1/4"	19"	100	380
1/4"	19 1/4"	100	385
1/4"	19 1/2"	100	390
1/4"	19 3/4"	100	395
1/4"	20"	100	400
1/4"	20 1/4"	100	405
1/4"	20 1/2"	100	410
1/4"	20 3/4"	100	415
1/4"	21"	100	420
1/4"	21 1/4"	100	425
1/4"	21 1/2"	100	430
1/4"	21 3/4"	100	435
1/4"	22"	100	440
1/4"	22 1/4"	100	445
1/4"	22 1/2"	100	450
1/4"	22 3/4"	100	455
1/4"	23"	100	460
1/4"	23 1/4"	100	465
1/4"	23 1/2"	100	470
1/4"	23 3/4"	100	475
1/4"	24"	100	480
1/4"	24 1/4"	100	485
1/4"	24 1/2"	100	490
1/4"	24 3/4"	100	495
1/4"	25"	100	500
1/4"	25 1/4"	100	505
1/4"	25 1/2"	100	510
1/4"	25 3/4"	100	515
1/4"	26"	100	520
1/4"	26 1/4"	100	525
1/4"	26 1/2"	100	530
1/4"	26 3/4"	100	535
1/4"	27"	100	540
1/4"	27 1/4"	100	545
1/4"	27 1/2"	100	550
1/4"	27 3/4"	100	555
1/4"	28"	100	560
1/4"	28 1/4"	100	565
1/4"	28 1/2"	100	570
1/4"	28 3/4"	100	575
1/4"	29"	100	580
1/4"	29 1/4"	100	585
1/4"	29 1/2"	100	590
1/4"	29 3/4"	100	595
1/4"	30"	100	600
1/4"	30 1/4"	100	605
1/4"	30 1/2"	100	610
1/4"	30 3/4"	100	615
1/4"	31"	100	620
1/4"	31 1/4"	100	625
1/4"	31 1/2"	100	630
1/4"	31 3/4"	100	635
1/4"	32"	100	640
1/4"	32 1/4"	100	645
1/4"	32 1/2"	100	650
1/4"	32 3/4"	100	655
1/4"	33"	100	660
1/4"	33 1/4"	100	665
1/4"	33 1/2"	100	670
1/4"	33 3/4"	100	675
1/4"	34"	100	680
1/4"	34 1/4"	100	685
1/4"	34 1/2"	100	690
1/4"	34 3/4"	100	695
1/4"	35"	100	700
1/4"	35 1/4"	100	705
1/4"	35 1/2"	100	710
1/4"	35 3/4"	100	715
1/4"	36"	100	720
1/4"	36 1/4"	100	725
1/4"	36 1/2"	100	730
1/4"	36 3/4"	100	735
1/4"	37"	100	740
1/4"	37 1/4"	100	745
1/4"	37 1/2"	100	750
1/4"	37 3/4"	100	755
1/4"	38"	100	760
1/4"	38 1/4"	100	765
1/4"	38 1/2"	100	770
1/4"	38 3/4"	100	775
1/4"	39"	100	780
1/4"	39 1/4"	100	785
1/4"	39 1/2"	100	790
1/4"	39 3/4"	100	795
1/4"	40"	100	800
1/4"	40 1/4"	100	805
1/4"	40 1/2"	100	810
1/4"	40 3/4"	100	815
1/4"	41"	100	820
1/4"	41 1/4"	100	825
1/4"	41 1/2"	100	830
1/4"	41 3/4"	100	835
1/4"	42"	100	840
1/4"	42 1/4"	100	845
1/4"	42 1/2"	100	850
1/4"	42 3/4"	100	855
1/4"	43"	100	860
1/4"	43 1/4"	100	865
1/4"	43 1/2"	100	870
1/4"	43 3/4"	100	875
1/4"	44"	100	880
1/4"	44 1/4"	100	885
1/4"	44 1/2"	100	890
1/4"	44 3/4"	100	895
1/4"	45"	100	900
1/4"	45 1/4"	100	905
1/4"	45 1/2"	100	910
1/4"	45 3/4"	100	915
1/4"	46"	100	920
1/4"	46 1/4"	100	925
1/4"	46 1/2"	100	930
1/4"	46 3/4"	100	935
1/4"	47"	100	940
1/4"	47 1/4"	100	945
1/4"	47 1/2"	100	950
1/4"	47 3/4"	100	955
1/4"	48"	100	960
1/4"	48 1/4"	100	965
1/4"	48 1/2"	100	970
1/4"	48 3/4"	100	975
1/4"	49"	100	980
1/4"	49 1/4"	100	985
1/4"	49 1/2"	100	990
1/4"	49 3/4"	100	995
1/4"	50"	100	1000
1/4"	50 1/4"	100	1005
1/4"	50 1/2"	100	1010
1/4"	50 3/4"	100	1015
1/4"	51"	100	1020
1/4"	51 1/4"	100	1025
1/4"	51 1/2"	100	1030
1/4"	51 3/4"	100	1035
1/4"	52"	100	1040
1/4"	52 1/4"	100	1045
1/4"	52 1/2"	100	1050
1/4"	52 3/4"	100	1055
1/4"	53"	100	1060
1/4"	53 1/4"	100	1065
1/4"	53 1/2"	100	1070
1/4"	53 3/4"	100	1075
1/4"	54"	100	1080
1/4"	54 1/4"	100	1085
1/4"	54 1/2"	100	1090
1/4"	54 3/4"	100	1095
1/4"	55"	100	1100
1/4"	55 1/4"	100	1105
1/4"	55 1/2"	100	1110
1/4"	55 3/4"	100	1115
1/4"	56"	100	1120
1/4"	56 1/4"	100	1125
1/4"	56 1/2"	100	1130
1/4"	56 3/4"	100	1135
1/4"	57"	100	1140
1/4"	57 1/4"	100	1145
1/4"	57 1/2"	100	1150
1/4"	57 3/4"	100	1155
1/4"	58"	100	1160
1/4"	58 1/4"	100	1165
1/4"	58 1/2"	100	1170
1/4"	58 3/4"	100	1175
1/4"	59"	100	1180
1/4"	59 1/4"	100	1185
1/4"	59 1/2"	100	1190
1/4"	59 3/4"	100	1195
1/4"	60"	100	1200
1/4"	60 1/4"	100	1205
1/4"	60 1/2"	100	1210
1/4"	60 3/4"	100	1215
1/4"	61"	100	1220
1/4"	61 1/4"	100	1225
1/4"	61 1/2"	100	1230
1/4"	61 3/4"	100	1235
1/4"	62"	100	1240
1/4"	62 1/4"	100	1245
1/4"	62 1/2"	100	1250
1/4"	62 3/4"	100	1255
1/4"	63"	100	1260
1/4"	63 1/4"	100	1265
1/4"	63 1/2"	100	1270
1/4"	63 3/4"	100	1275
1/4"	64"	100	1280
1/4"	64 1/4"	100	1285
1/4"	64 1/2"	100	1290
1/4"	64 3/4"	100	1295
1/4"	65"	100	1300
1/4"	65 1/4"	100	1305
1/4"	65 1/2"	100	1310
1/4"	65 3/4"	100	1315
1/4"	66"	100	1320
1/4"	66 1/4"	100	1325
1/4"	66 1/2"	100	1330
1/4"	66 3/4"	100	1335
1/4"	67"	100	1340
1/4"	67 1/4"	100	1345
1/4"	67 1/2"	100	1350
1/4"	67 3/4"	100	1355
1/4"	68"	100	1360
1/4"	68 1/4"	100	1365
1/4"	68 1/2"	100	1370
1/4"	68 3/4"	100	1375
1/4"	69"	100	1380
1/4"	69 1/4"	100	1385
1/4"	69 1/2"	100	1390
1/4"	69 3/4"	100	1395
1/4"	70"	100	1400
1/4"	70 1/4"	100	1405
1/4"	70 1/2"	100	1410
1/4"	70 3/4"	100	1415
1/4"	71"	100	1420
1/4"	71 1/4"	100	1425
1/4"	71 1/2"	100	1430
1/4"	71 3/4"	100	1435
1/4"	72"	100	1440
1/4"	72 1/4"	100	1445
1/4"	72 1/2"	100	1450
1/4"	72 3/4"	100	1455
1/4"	73"	100	1460