



RAPID-TORC® RT Serie

If you ask for an Industrial Heavy Duty Tool You will appreciate the quality of Rapid-Torc® RT

The « Standard » for all your Heavy Duty Application

Key Benefits:

- 9 Models from 55 ft-lbs up to 52.500 ft-lbs
- 5 Models of Square Drive : 1/2", 3/4", 1", 1 1/2", 2 1/2"
- Hand-Free operations
- One Way Ratchet System
- Heavy Duty Ratchet Mechanism
- Double Acting Operation
- Splinned Square Drive.
- Multi-Position Adjustable Reaction Arm with a Rapid-Lock Mechanism
- Large attachment between Piston Rod End and Drive mechanism.
- No tools required for square drive reversibility from Tightening to loosening.
- Very high ratio Torque / Weight
- Tight Radius.
- Monobloc housing CNC Designed
- Anti Side Load Resistant Design
- Robust Double Tooth Ratchet Mechanism
- Never-Lock Torque Mechanism
- Uni-Swivel Multi Axis 360° x 180° (same on RT-X Tools)
- Uni-Body Housing made from the best Aircraft Quality Aluminum
- Output Accuracy certified at +/- 3%
- Certified accuracy traceable to NIST
- Heavy duty Finish for a Fully Corrosion resistance
- CE approved



Accessories available:

Hex Drive, Step-up & Step-Down drive and a large choice of Reaction Arms including extended and Alco Arms.



RAPID-TORC
 BIG NUTS - BIG TOOL
 WWW.RAPIDTORC.COM



RAPID-TORC® RT Serie

Models		RT-.5	RT-1	RT-3	RT-5	RT-8	RT-10	RT-20	RT-25	RT-50
Square Drive		1/2"	3/4"	1"	1 1/2"	1 1/2"	1 1/2"	2 1/2"	2 1/2"	2 1/2"
Min Torque	Ft-lbs	55	200	480	835	1200	1755	2960	3960	7875
	Nm	75	271	651	1132	1627	2379	4013	5368	10675
Max Torque	Ft-lbs	397	1340	3230	5590	8000	11520	19760	25890	52500
	Nm	538	1817	4379	7578	10845	15617	26787	35096	71169
Weight	Lbs	0.88	4.1	8.3	16.5	29.5	26.8	54.3	68	132
	Kg	0,4	1,9	3,9	7,5	11,5	13,4	24,7	31	60
L1	inch	3,15	4,68	6,04	7,21	7,85	9	10,2	12	15,2
	mm	81	120	155	185	202	232	259	310	390
L2	inch	4,87	7,13	9,24	11,23	12,49	13,9	16,55	18,4	23,9
	mm	125	183	237	288	321	357	420	473	615
H1	inch	2,35	3,52	4,68	5,63	6,42	7,2	8,5	9,1	11,4
	mm	60,5	90,5	120	144,5	164,61	186	216	234	294
H2	inch	3,62	4,75	6,08	7,05	8,4	9,3	9,9	11	13,4
	mm	93	122	156	181	213,36	239	251	282	344
R1	inch	0,52	0,9	1,28	1,44	1,62	1,87	2,17	2,37	30,8
	mm	13,5	23	33	37	41	48	55,11	61	79
W1	inch	1,3	1,95	2,59	3,12	3,48	3,9	4,7	5,2	6,5
	mm	33,5	50	66,5	80	88	100	119	134	167
W2	inch	1,97	2,76	3,72	4,9	4,95	5,5	6,7	7,4	8,9
	mm	50,5	71	95,5	126	126	142,5	170	191	228

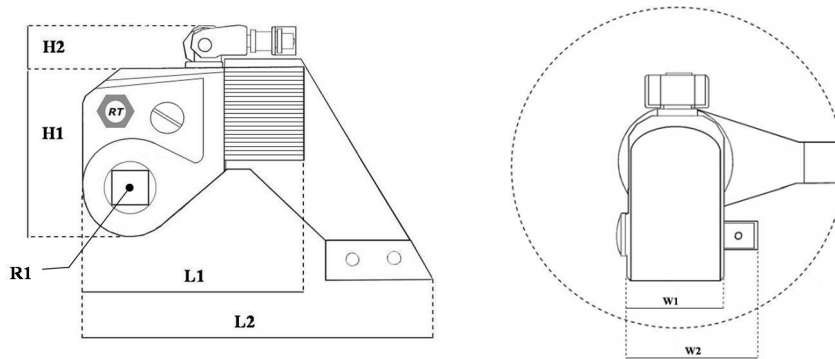

Reaction arms

